

# JIS F3307

# Turnbuckle for Anchor Stoppers



Turnbuckles are used with steel cables for getting rid of slack made between two points, and are a kind of binding used for tightening.

Material : body : SS400  
Joe Bolt : S25C  
Pin : S25C

Surface Treatment : Hot Dip Galvanizing

\*\*We can also manufacture the products by using other materials and applying surface treatment other than the above.

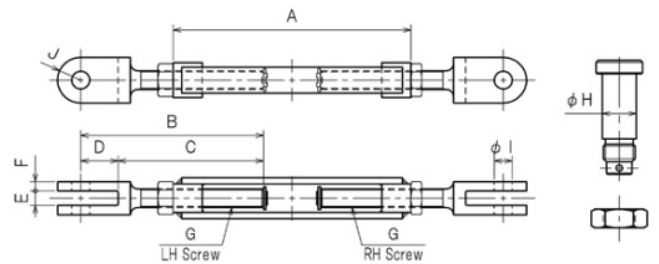

	(mm)										
Size	A	B	C	D	E	F	G	H	I	J	W.L.L. (Ton)
2.0	230	167	135	32	12	7	M16	13	14	18	1.15
5.0	300	221	175	46	16	11	M24	20	21	28	2.82
6.0	360	266	215	51	18	12	M27	23	24	32	3.46
8.0	400	297	240	57	20	13	M30	26	27	36	4.50
10.0	430	323	260	63	22	15	M33	29	30	41	5.71
12.5	450	346	275	71	28	18	M36	32	34	44	7.10
16.5	470	375	295	80	30	20	M42	36	38	50	9.29
21.5	510	418	325	93	34	22	M48	42	44	60	12.41
26.0	530	441	340	101	36	24	M52	47	49	67	15.01
31.0	570	461	350	111	39	26	M56	51	53	73	17.89

AUZAC CO.,LTD.

26-229, Tomochoushiroji, Fukuyama-shi, Hiroshima, Japan

mail:info@auzac.jp

HP:https://www.auzac.jp/en/

 **AUZAC**  
AUZAC CO.,LTD.